

10/23/21, 2:12 PM

Sotheby's International Realty Canada Mail - The Capitol Residences – It's Not Downsizing, it's UPLIVING!

Frank Farhangi, Broker, SVP Sales, Phone: +1-647-296-5489



Frank Farhangi <ffarhangi@sothebysrealty.ca>

The Capitol Residences – It's Not Downsizing, it's UPLIVING!

1 message

International Home Marketing Group Realty Inc. <thecapitol@madisongroup.ca>

Thu, Oct 21, 2021 at 12:59 PM

Reply-To: "International Home Marketing Group Realty Inc." <thecapitol@madisongroup.ca>

To: Frank Farhangi <ffarhangi@sothebysrealty.ca>

Frank Farhangi, Broker, SVP Sales, Sotheby's International Realty Canada, ffarhangi@sothebysrealty.ca , +1-647-296-5489

*Prices and specifications are subject to change without notice. The information provided herein must only be used by consumers that have a bona-fide interest in the purchase, sale or lease of real estate. We are cooperating brokers and do not represent the developers. E. & O.E.

THE CAPITOL

YONGE AT CASTLEFIELD



**CLICK HERE TO VIEW
AVAILABLE SUITES**

PASSWORD: VIPBROKER

Frank Farhangi, Broker, SVP Sales, Sotheby's International Realty Canada, ffarhangi@sothebysrealty.ca, +1-647-296-5489

*Prices and specifications are subject to change without notice. The information provided herein must only be used by consumers that have a bona-fide interest in the purchase, sale or lease of real estate. We are cooperating brokers and do not represent the developers. E. & O.E.

IT'S NOT DOWNSIZING, IT'S UPLIVING

Elevating your space to new heights of sophistication, the exquisite Studio Munge signature kitchen invites the most discerning clientele to express their individuality and sense of style.

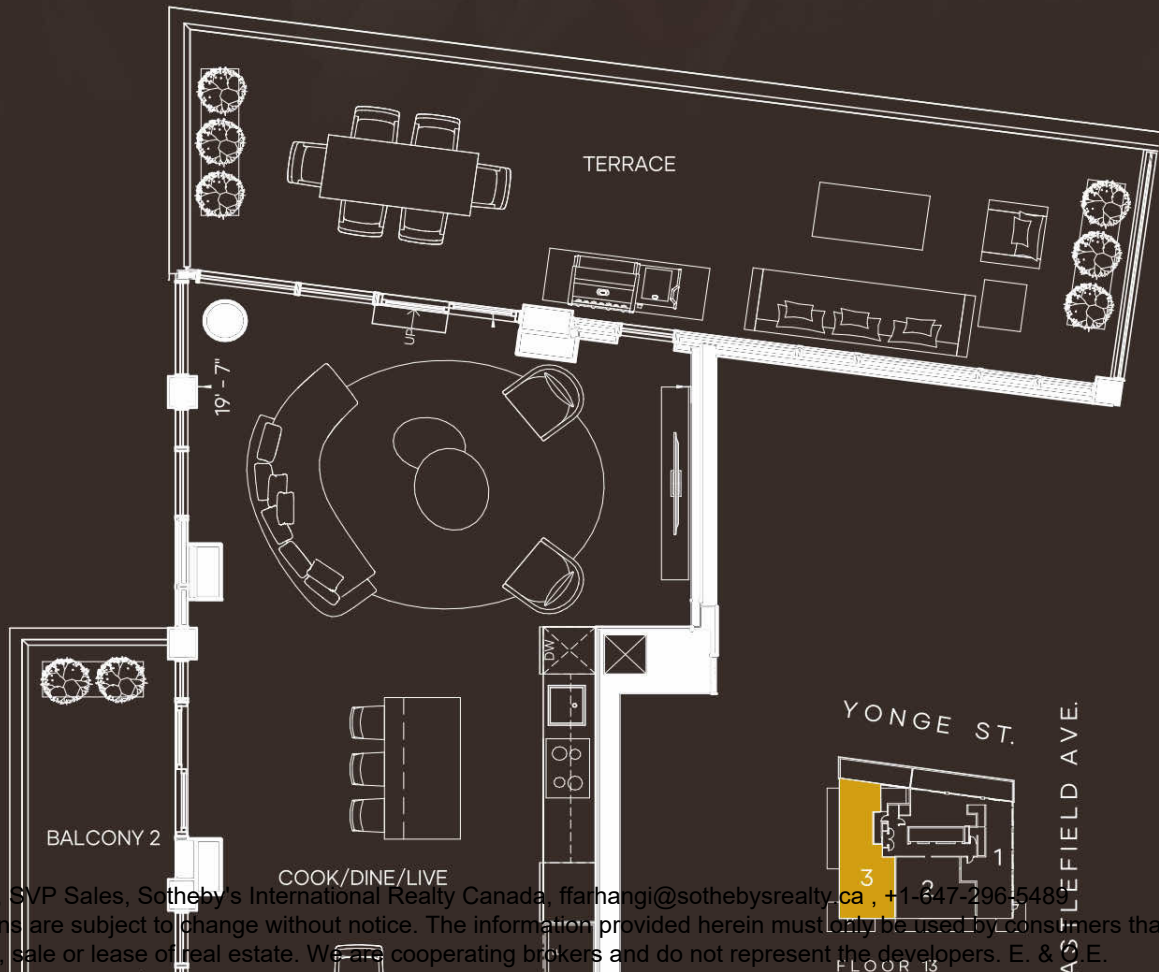

Frank Farhangi, Broker, SVP Sales, Sotheby's International Realty Canada, ffarhangi@sothebysrealty.ca, +1-647-296-5489
*Prices and specifications are subject to change without notice. The information provided herein must only be used by consumers that have a bona-fide interest in the purchase, sale or lease of real estate. We are cooperating brokers and do not represent the developers. E. & J. E.

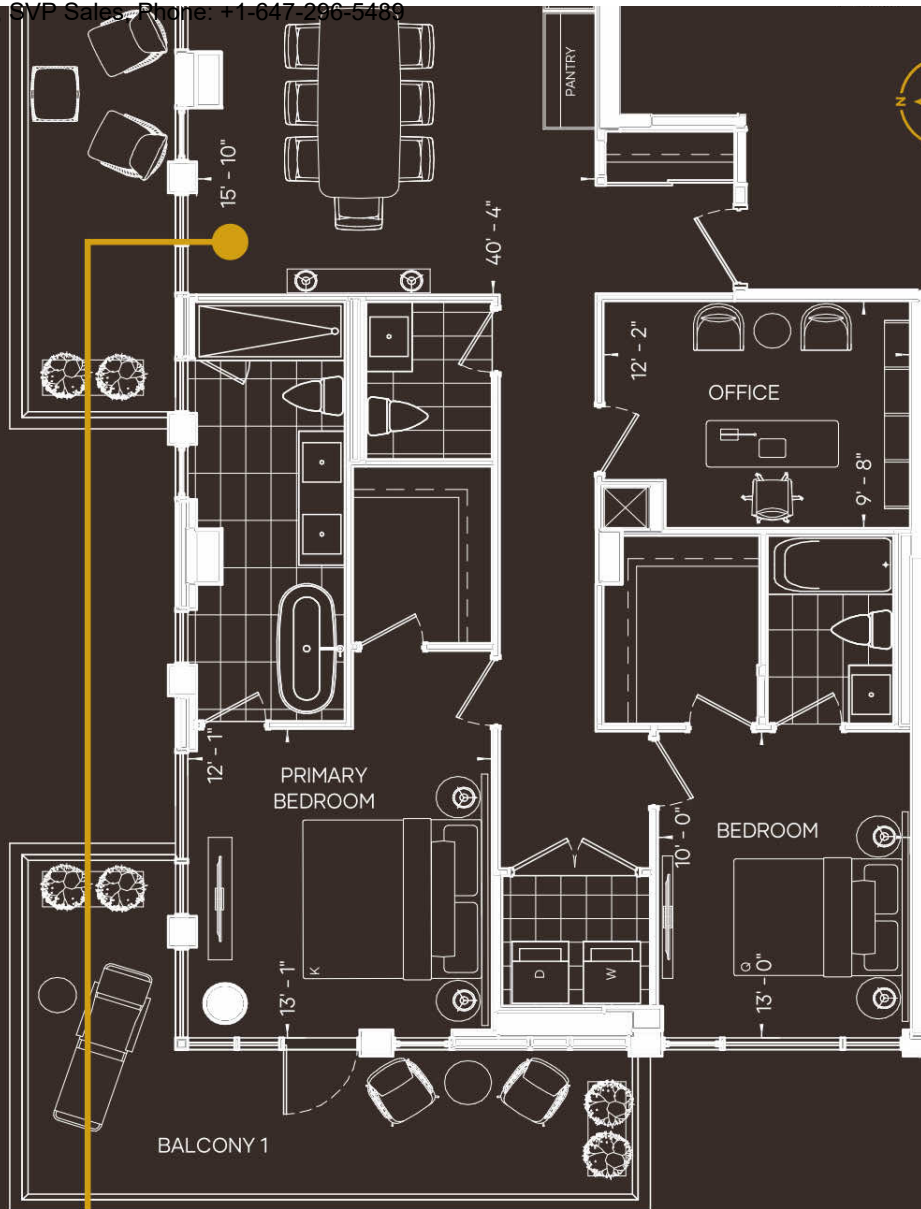

PREMIERE PENTHOUSE - P2C+D(T) 1,800 SQ.FT.

 **2** BEDROOMS
 **1** OFFICE
 **2.5** BATHS

TERRACE - 380 SQ.FT.
 BALCONY 1 - 230 SQ.FT
 BALCONY 2 - 180 SQ.FT.



Developed by



For frequent updates follow us on Instagram
@MadisonHomes

[MadisonGroup.ca](https://www.MadisonGroup.ca)

* Prices subject to change without notice. Rendering is artist's concept only.
Marketed by International Home Marketing Group Realty Inc., Brokerage. Brokers Protected. E. & O.E. October 2021

Exclusive listing brokerage: International Home Marketing Group Realty Inc., brokerage.

[unsubscribe from all broker emails](#)